

FW-3000

(Direct Chill)

Cold , Room and Hot Water Dispenser

Operation Manual

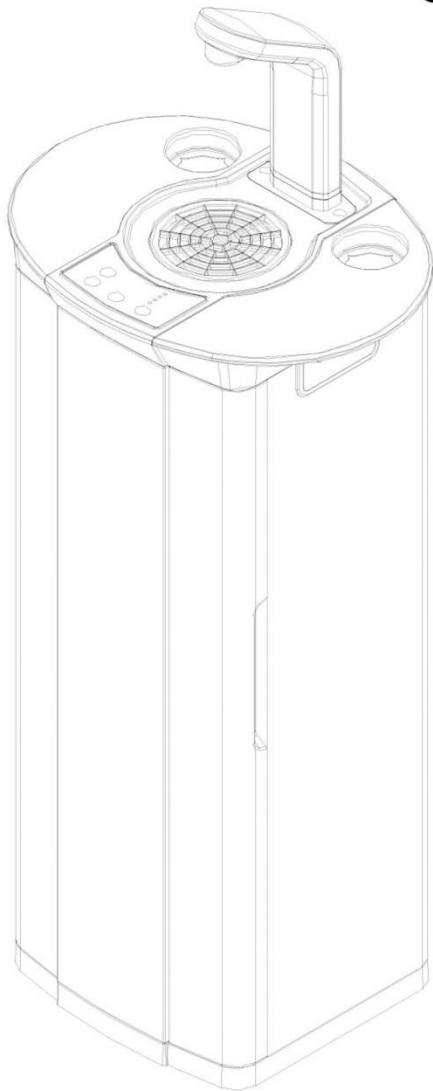

Contents	Page
Preface / Parts	1
Assembly Drawings	2
Piping Installation	3
Cup Holder Instructions	4
Operation Method	5,6
Level Sensor Instructions	7
Safety Reminder	8
Cleaning & Maintenance	9

Please read these instructions completely before operating this unit

Preface / Parts

Before using this machine, we advise you to read this manual thoroughly. Please follow the instructions for proper operation to prevent risk or damage.

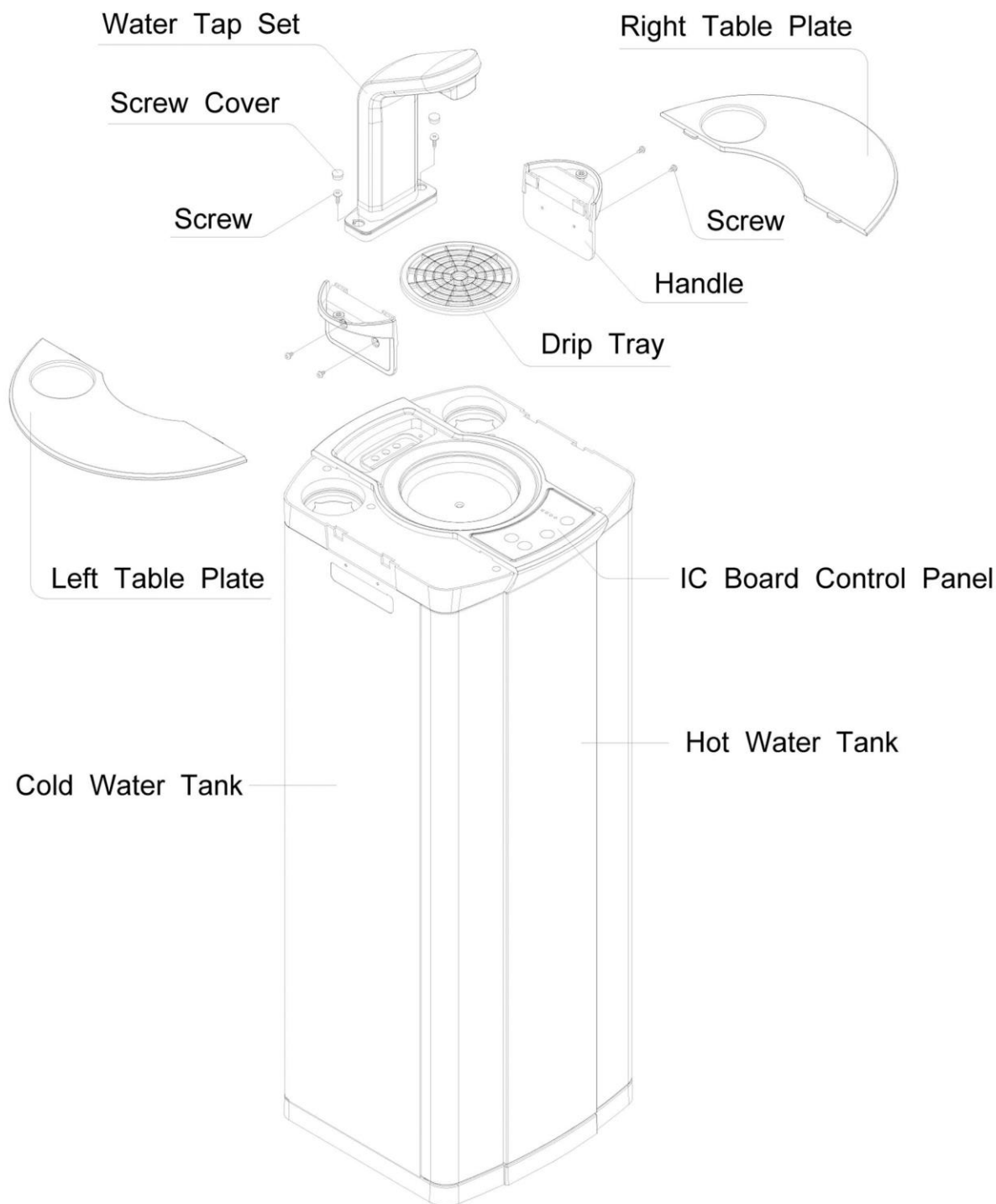

Assembly Drawings

Please follow the drawings for water dispenser assembly.

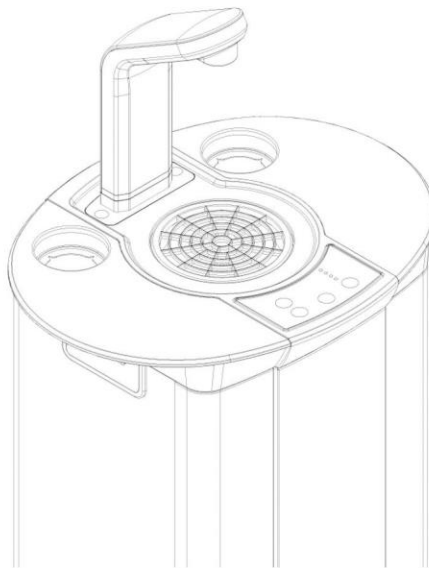
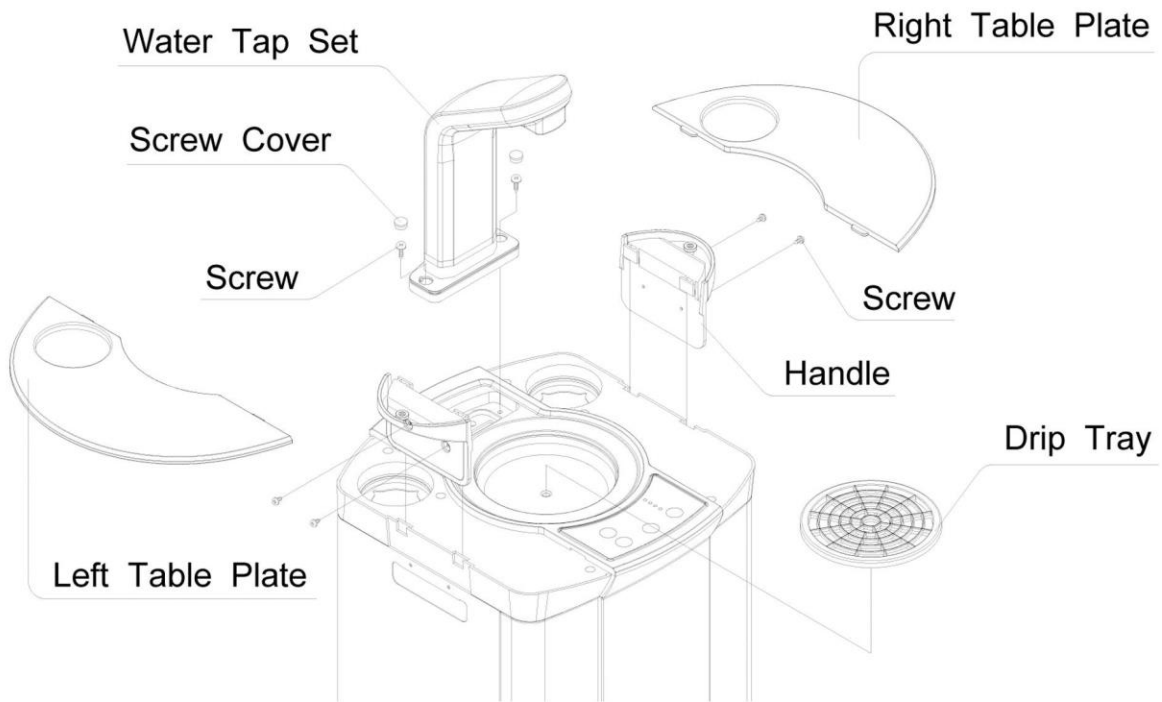

Completion Drawing

Piping Installation

1. Disassemble the original water tap, then put on the tri-way socket and inlet ball valve. See drawing(A).



Drawing (A)

2. Connect the 1/4" PE water pipe between inlet ball valve and inlet connector. See drawing (B).

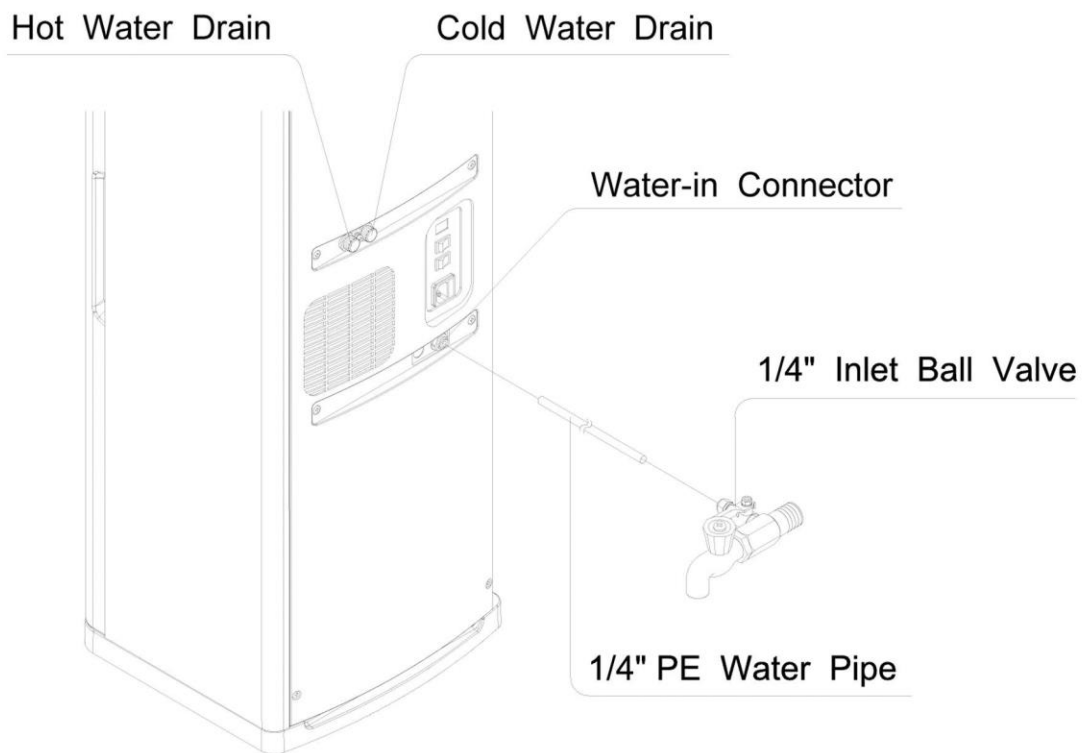

Drawing (B)

Cup Holder Instructions

1. Push cups all the way down as the arrow is showing till no more may fit in.

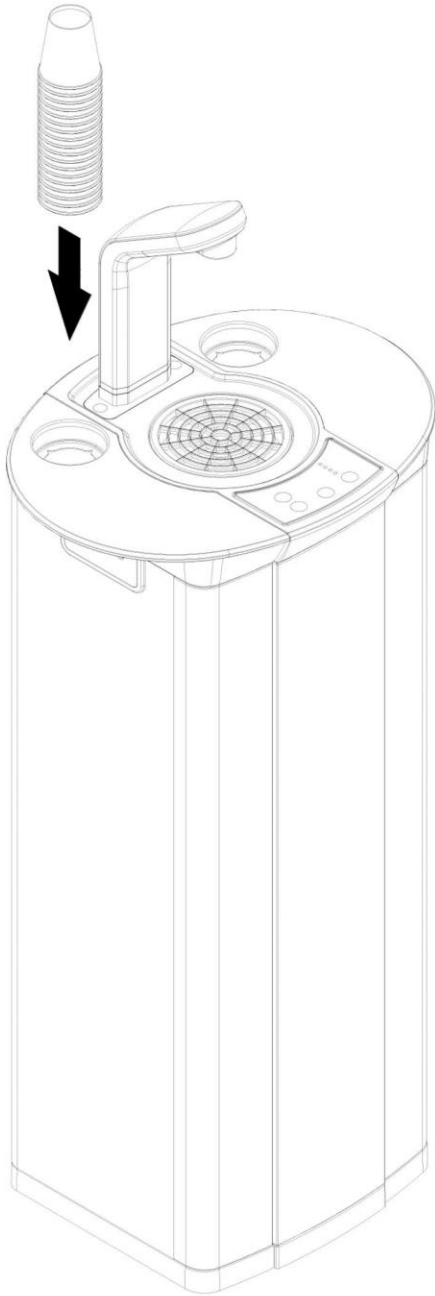

2. Simply pull out the cups gently when needed.

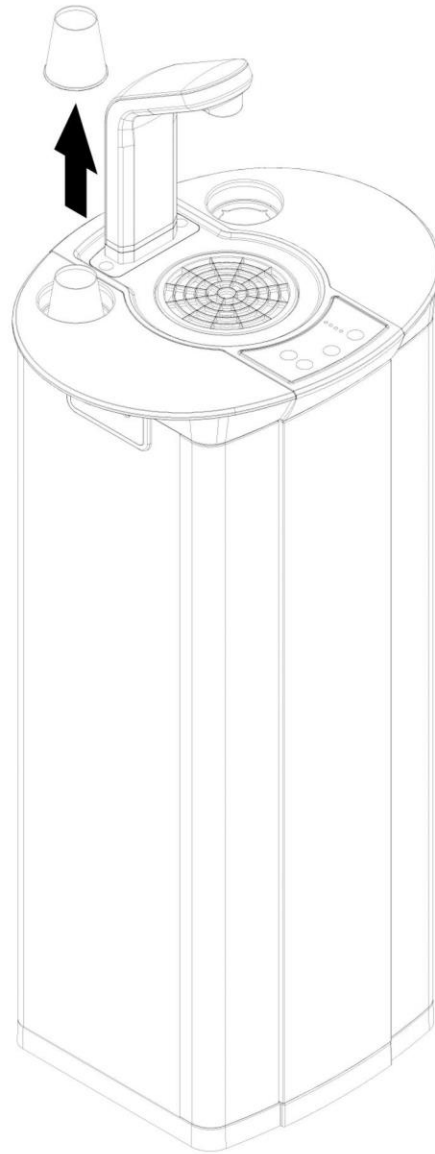

Operation Method

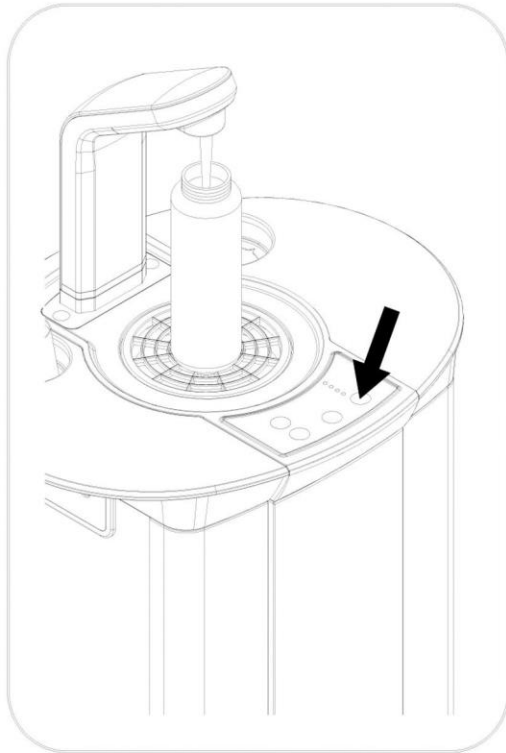

1. When piping is completed, the tanks will begin to fill with water. Now the machine may be connected to electricity. Try pressing the cold and hot water buttons and see if water comes out. It is important that the tanks must be filled with water to proceed with the following procedures.

2. Turn on the cold power switch on the back and chilling starts. The chilling indicator on the control board will go on as chilling proceeds. When the indicator goes off, chilling is done. The temperature is set at 4 ~ 10°C.

3. Turn on the hot power switch on the back and heating starts. The heating indicator goes on while heating proceeds. When the indicator is off, heating is done and hot water is ready to serve. Hot water will be re-heated automatically when the temperature is not high enough.

4. To have hot water, press the safety lock first, then press hot water button. After 5 seconds, the hot water button locks up automatically.

5. To have room temp water, press the room water button.

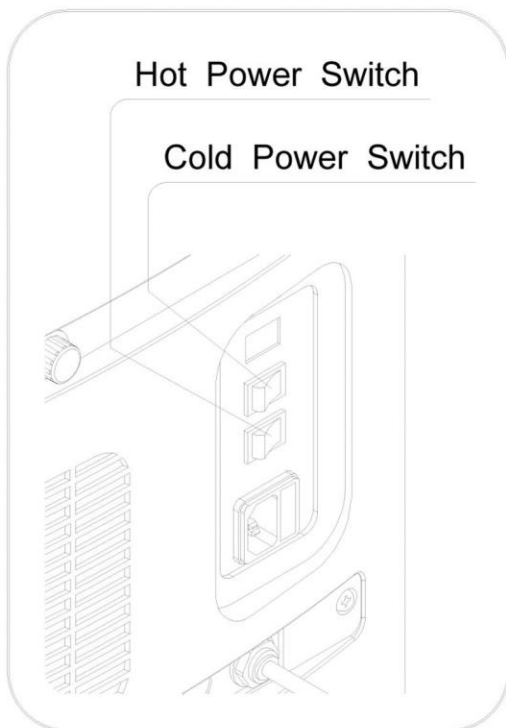

Operation Method

6. Water will stop providing when any of the three water buttons is pressed over 60 seconds. Please release the water button to reset. Press again for more water.

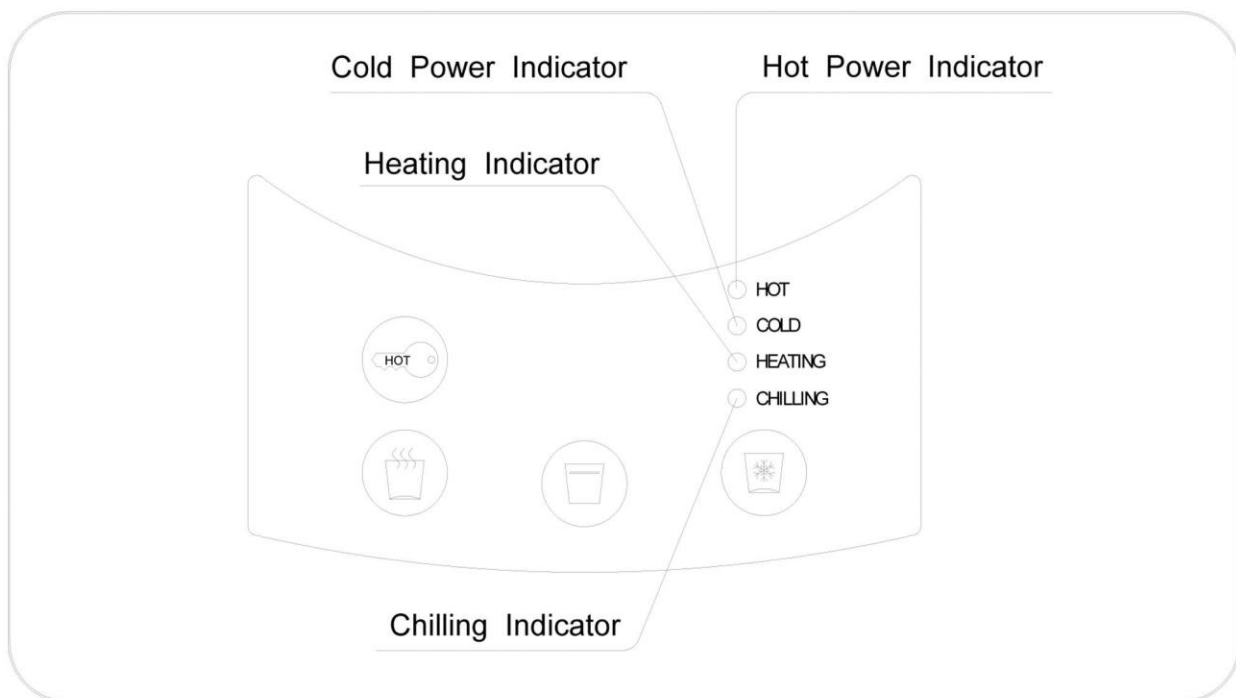
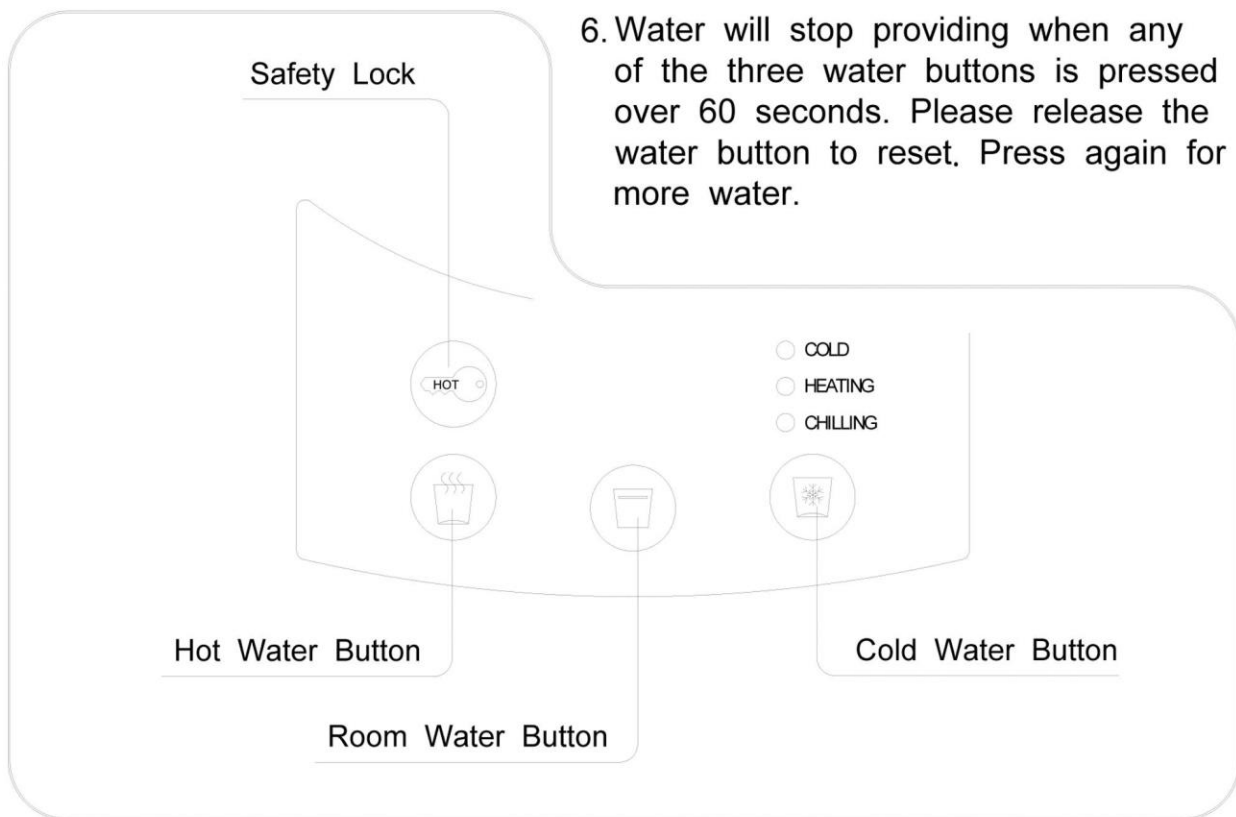

Level Sensor Instructions

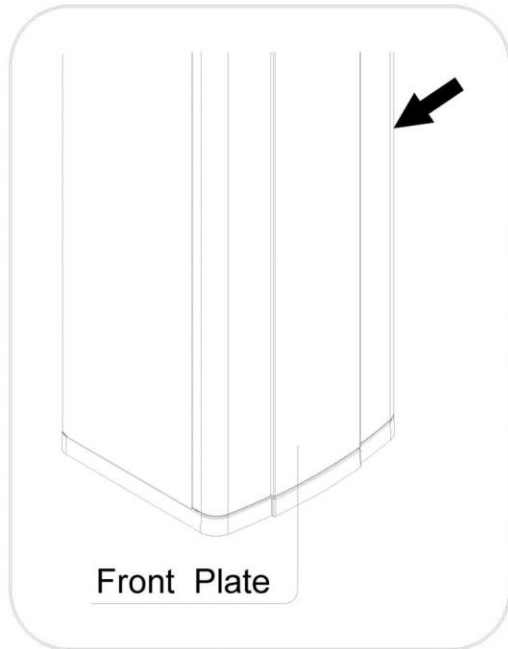

1. Open the lower front plate from the right side as where the arrow is pointing and the container may be seen .

2. Place the level sensor on the container .

3. After pressing the water button , if there's no water drain , LED light flashes , buzzer sounds ; meaning the drain container fills with water . Please dump the waste water and replace the drain container . Machine will work normally .

Remark:

When LED light blinks continually , meaning water leaks . Please unplug , dry the detection probes and channel on the base plate . Plug-in , machine will work normally .

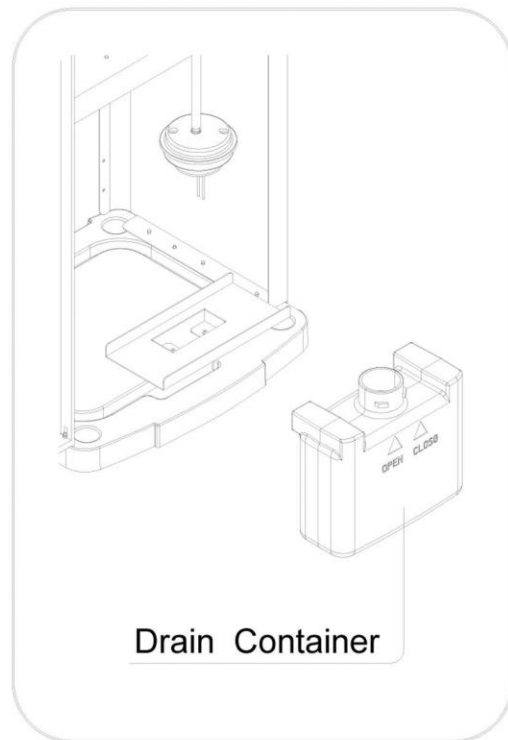
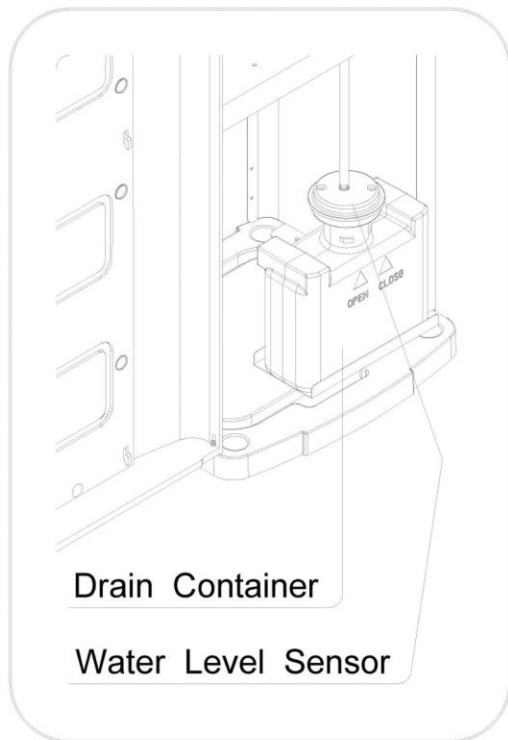

Safety Reminder

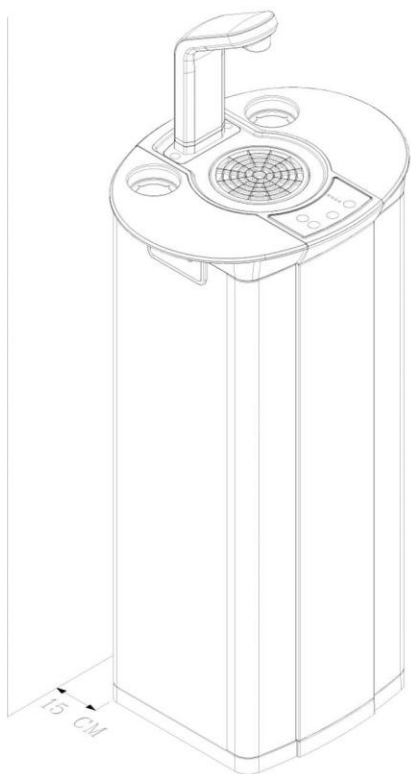

Leave a space no less than 15cm between the wall and dispenser.



Keep the machine away from sunlight , heat , and wetness.

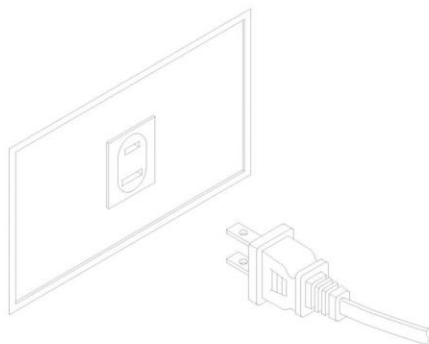

Be sure to use single outlet socket with correct power voltage. Plug the power cord directly into electrical socket .

Cleaning & Maintenance

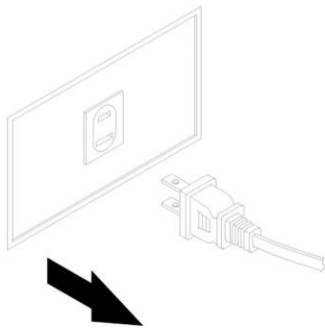

1. Please make sure the machine is completely disconnected from electricity before cleaning.

Hot Water Drain

Cold Water Drain

Caps

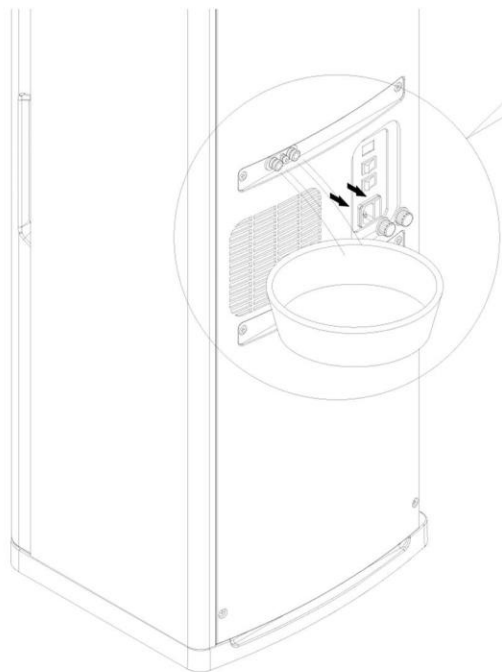
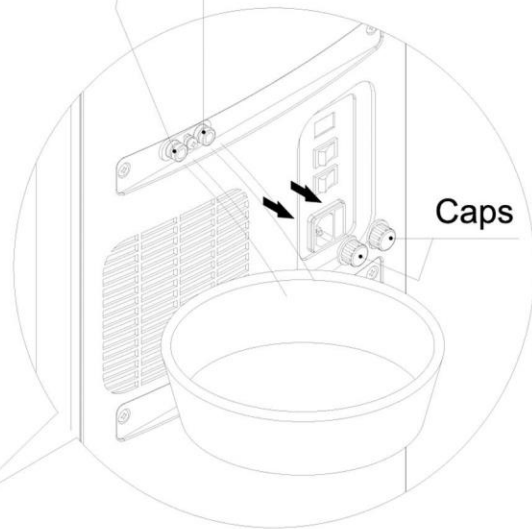

2. Remove the caps on top of the hot water and cold water drains. The remaining water in the tanks will drain out. Cleaning may start when both tanks are emptied. Please put the caps back when cleaning is done.

Caution: For your safety, please contact your distributor or qualified technician for repair when the water dispenser is damaged.



Mailing Address:
FilterWater.com
P.O.Box 968
Southampton, PA 18966
USA

<http://www.FilterWater.com>

Tel. +1 (800) 439-0263

Fax +1 (215) 354-0304

Email: Sales@filterwater.com